

TYPICAL CROSS SECTION  
FOR ARTERIAL STREET  
DETAIL "A"

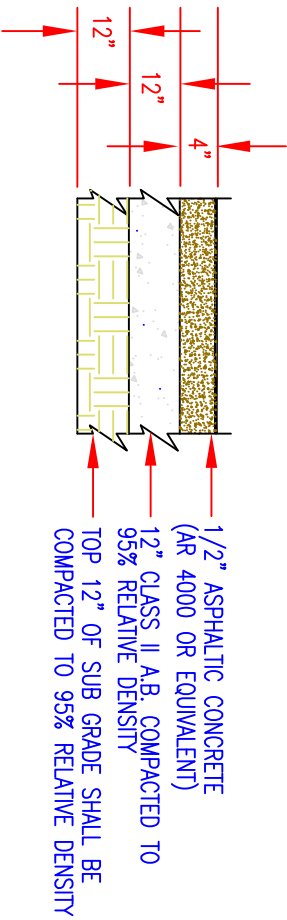

TYPICAL CROSS SECTION  
FOR A COLLECTOR STREET  
DETAIL "B"



CITY OF OROVILLE DEPARTMENT OF PUBLIC WORKS		
STANDARD FOR ARTERIAL AND COLLECTOR STREETS		
DRAWN BY: SG	RICK WALLS, P.E. DIRECTOR OF PUBLIC WORKS DEPARTMENT	SHEET 1 OF 1 ST-01